



RE/MAX CREST REALTY
101 - 2609 WESTVIEW DR.
NORTH VANCOUVER, B.C.

TAZMEEN WOODALL

tel: 604-988-8000

fax: 604-985-3612

#103-1111 LYNN VALLEY RD.
NORTH VANCOUVER

TOTAL 595 SQ.FT.

PATIO 202 SQ.FT.

PATIO
14'11"X 10'3"

LIVING ROOM
11'1"X 10'0"

BEDROOM
10'11"X 10'3"

DINING ROOM
11'1"X 9'8"

KITCHEN
8'8"X 8'7"

ENTRY

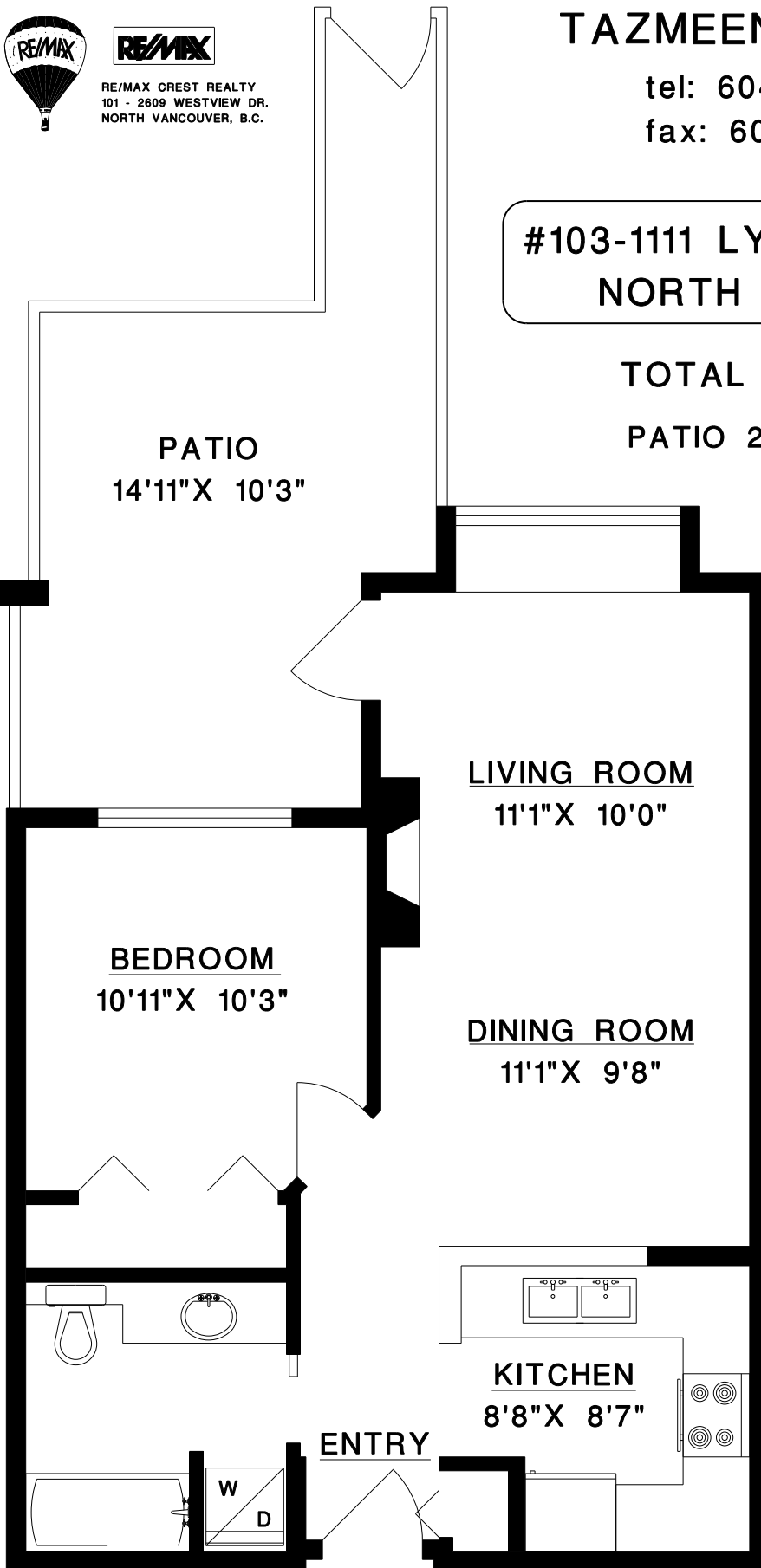

FILE: 1074-38
DATE: OCT/09

